

PIN-Belegung / PIN Assignment

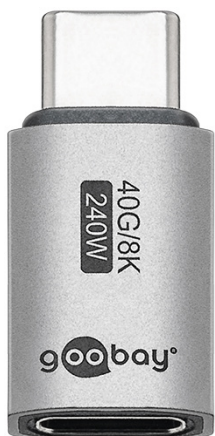
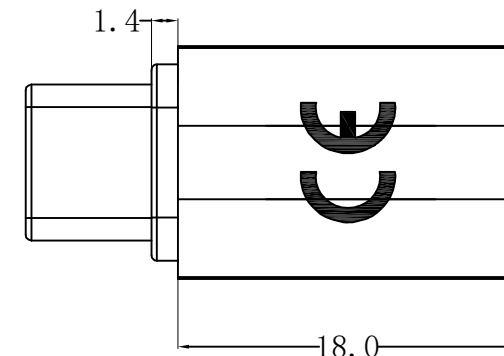
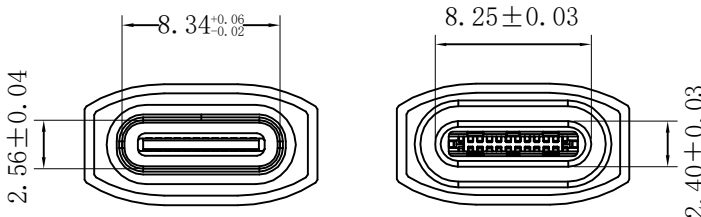
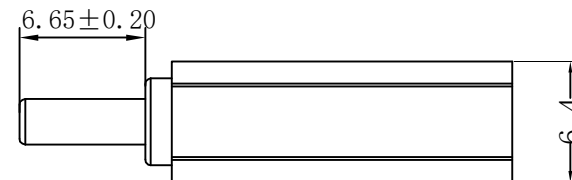
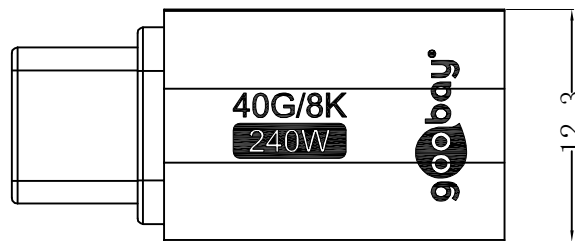
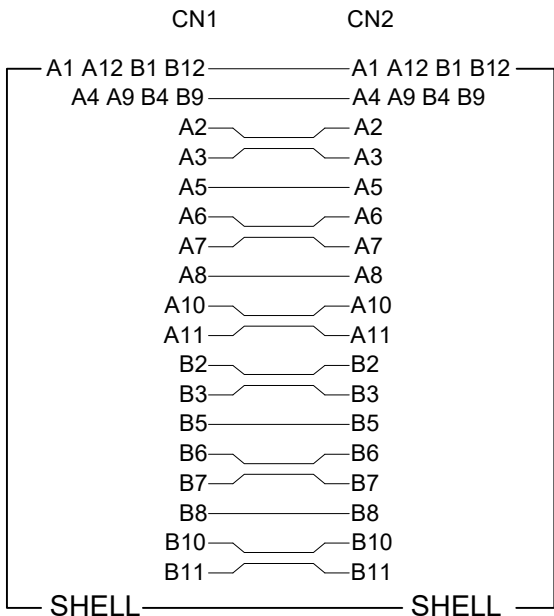

USB-C™-Adapter gerade, USB4™

- Sorgt für eine platzsparende Kabelführung
- Hochwertiges, robustes Metallgehäuse
- Kompatibel mit USB 3.1, USB 2.0, Thunderbolt™ 3 und Thunderbolt™ 4

Anschlüsse: USB-C™-Stecker, USB-C™-Buchse
Kontakte: vernickelt
Material Gehäuse: PINs: vergoldet
 Innen: PVC 45P, schwarz
 Außen: Aluminiumlegierung
Max. Auflösung: 8K @ 60 Hz
Max. Datenübertragungsrate: 40 Gbit/s
Leistung: Max. 240 W (48 V ; 5A)
Isolationswiderstand: 300 V/10ms === , ≥10 MΩ

USB-C™ Adapter Straight, USB4™

- Ensures space-saving cable routing
- High-quality, robust metal housing
- Compatible with USB 3.1, USB 2.0 as well as Thunderbolt™ 3 and Thunderbolt™ 4

Connectors: USB-C™ plug, USB-C™ socket
Contacts: nickel-plated
Material housing: PINs: gold plated
 Inside: PVC 45P, black
 Outside: Aluminium alloy
Max. Resolution: 8K @ 60 Hz
Max. Data transmission rate: 40 Gbit/s
Power: Max. 240 W (48 V ; 5A)
Insulation resistance: 300 V/10ms === , ≥10 MΩ

Änderungen

Datum	Name	gez.:	Datum	Name	Bezeichnung	Blatt
		gez.:	25.07.2024	fw	USB-C 4.0 240W 40G Adapter Flach F-M	
		gepr.:	25.07.2024	fw		
		Norm:			Zeichnungs-Nr.:	von
Änderungen vorbehalten / Subject to change					74447	

